



Greetings from sunny Singapore!

STUDENT EXCHANGE

NATIONAL UNIVERSITY
OF SINGAPORE



Global Relations Office

HELLO FROM **SINGAPORE!**

where innovation, cultures
and the future meet



Located in the heart of Southeast Asia
1 degree above the equator (High humidity!)
Summer all year round (~30° C or 88° F)

We are so small (720 km² or 280 miles²), we are affectionately known as the "Little Red Dot"!





WHY SINGAPORE?



World's most competitive economy



English speaking



One of the world's safest city for travelers



Seamless and efficient public transportation system

but there's more...



LUSH GREENERY AT YOUR DOORSTEP

Urban living and tropical nature
in harmony

UNESCO World Heritage Garden



" Two million trees have been planted here in the last 45 years.
This city is now richer in species than any other in the world. "



Sir David Attenborough

VIBRANT CULTURES PASSIONATE HEARTS

Amazing array of food
Festivals all year round
A city fueled by passion

"Singapore is possibly the most food-centric place on Earth, with the most enthusiastic diners, the most varied and abundant, affordable dishes - available for cheap - on a per-square-mile basis."



Anthony Bourdain

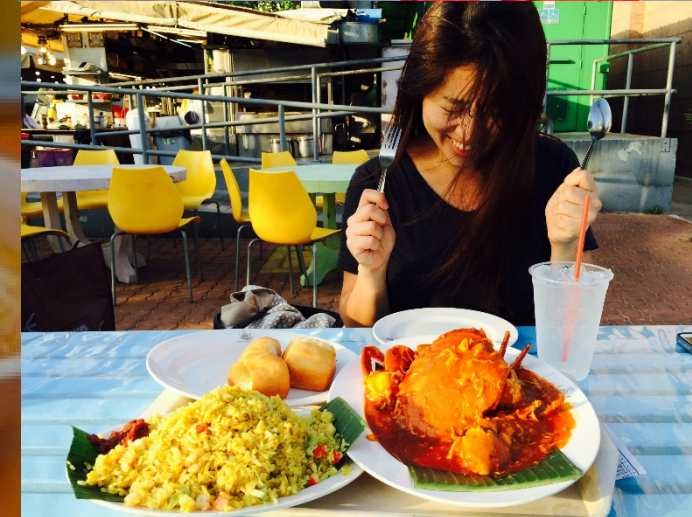

EXPLORE ASIA

World Heritage Sites,
Pristine Beaches and
more!



"Exchange at NUS was a great opportunity
to learn, travel and make friends with
people from all around the globe."
- Exchange student from Warsaw School of
Economics (Poland)





WHERE IS NUS?

Central West region

35 min to the city
(public transport)

30 min to the airport (taxi)



Fun fact!

NUS was founded in 1905 as a medical school and has grown into a university with 17 schools and faculties!



Global Relations Office

EXPLORE OUR CAMPUSES

Kent Ridge

(Main Campus, right)

Bukit Timah

(Law and Public Policy, below)

Outram

(Duke-NUS Medical School, not pictured)



Pro Tip:

All three NUS campuses are conveniently located near Mass Rapid Transit (MRT) stations. Kent Ridge and Bukit Timah campuses are also connected by a free internal shuttle!



Global Relations Office

CHECK OUT OUR CAMPUS!



Multiple food venues



Libraries and Museums



Sport Centres



Convenience Stores



Banks



University Health Centre



Internal Bus Network

And so much more!

"I love it here, I really do! The studying facilities are amazing and the campus is beautiful, the fact that we can enjoy the pools and gym for free is excellent."

- Exchange student from University of Dundee (UK)



#NUS !!



UNIVERSITY
TOWN



Fancy a Frappe?



Down for a game of
frisbee by Town Green?



Bubble tea fix!



Our very own infinity pool!



AYER RAJAH EXPRESSWAY

KENT
RIDGE
CAMPUS

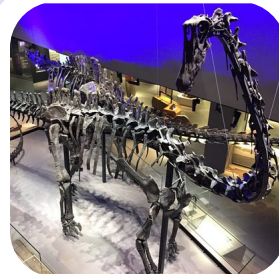

Magnificent dinosaurs at the
Natural History Museum!

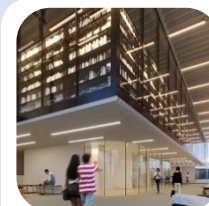

Even the library is
a hangout spot!



Gastronomical
Goodness.

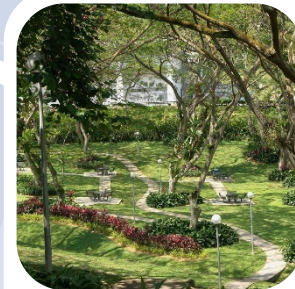

Campus by the ridge.



Global Relations Office

EXHILARATING EXCHANGE EXPERIENCE!



Forge friendships.
Create your NUS experience!



Welcome Party



Dragonboat



*Global Lounge
Meet-ups*



Coffee Get-Together

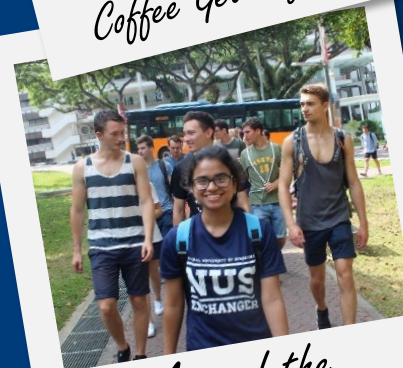

*Around the
school tours*



Farewell Party

Activities just for YOU,
exchange students!



STUDENT EXCHANGE

WHY NUS?



Comprehensive, global university centred in Asia!



All modules taught in English (except foreign language modules, of course!)



Over 2,000 exchange students every Academic Year



Tuition-fee waiver (reciprocal exchange)



Global Relations Office

LEARNING AT NUS

PARTICIPATING FACULTIES & SCHOOLS



Faculty of Arts &
Social Sciences



Faculty of
Engineering



Faculty of
Science



School of
Computing



School of Design &
Environment



NUS Business
School*



Faculty of
Law*



University
Scholars
Programmes*

*Business, Law and USP (Honours College) modules are often restricted to school/subject-specific exchanges. Please check with your study abroad advisor to see if you are eligible to take these modules based on the exchange agreement your home university has with NUS.

LEARNING AT NUS



"The educational quality at NUS is amazing. The lecturers are all very experienced and engaging."
- Exchange student from University of Melbourne (Australia)



Exchange students will enroll in 3 to 5 modules or courses each semester



NUS follows a lecture/tutorial system with lectures being held weekly and tutorials weekly or bi-weekly

Useful resources:

- ✓ [List of modules for exchange students](#)
- ✓ [List of restricted modules](#)
- ✓ [NUS Timetable Builder](#)

LIVING AT NUS

"The facilities were always kept clean and there were always a variety of events going on to give opportunities to interact with other students."
- Exchange student from University of Osaka (Japan)



Exchange students have the option to stay on or off campus



On-campus housing has limited spots therefore students are encouraged to be flexible and to research on- and off-campus options to be safe

Useful resources:

- ✓ [On-campus housing information](#)
- ✓ [Off-campus housing information](#)

LIVING AT NUS

ON-CAMPUS HOUSING OPTIONS



Halls of Residence

Tight-knit communities with lots of events and activities

Meal Plan | Single Rooms



Residential Colleges (RCs)

Integrated academic and residential experience

Meal Plan | Single Rooms (apartment-style or corridor)









Student Residences

Large housing complexes, independent living

No Meal Plan | Single Rooms (apartment-style or corridor)

***Due to limited housing, students are encouraged to be flexible with their housing options. All options may not appear on the housing application.**

ESTIMATED MONTHLY BUDGET (in GBP)

	On Campus	Off Campus
 Housing	£212 - £475	£334 - £725
 Food	£140 - £277	£224 - £450
 Public Transport	£58 - £100	£114 - £165
 Books & Stationery	£115 - £197	£114 - £197
 Personal Expenses	£140 - £197	£168 - £250
 Total (GBP)	£665 - £1,246	£954 - £1787



NUS
National University
of Singapore

Fun fact!

Despite being regarded as one of the most expensive cities in the world, Singapore can be an affordable exchange destination.

National University of Singapore

INTERESTED IN EXCHANGE TO NUS?



Speak to your study abroad advisor at your home university



Save your elective courses for your exchange semester (flexibility is key!)

*On-site orientation and registration will take place in late-July for Semester 1.

**The internal deadline for your home university will be earlier than this. Please check with your home university's International Office for more details on the timeline.

ACADEMIC CALENDAR & KEY DATES

Semester 1

Aug*

NUS applications due**
15 April

Semester 2

Dec

Jan

May

NUS applications due**
1 October



See you soon!

Useful resources:

- ✓ [Main Page for Incoming Exchange Students](#)
- ✓ [NUS Info Sheet](#)
- ✓ [Incoming Exchange Guide](#)



Global Relations Office

ENHANCED PRECAUTIONARY MEASURES AGAINST COVID-19 AT NUS

When you are enrolled in NUS, safeguarding your health and safety remains our utmost priority.

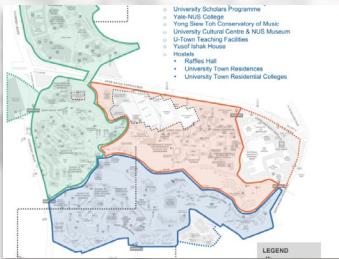

Zoning & increased cleaning across campus

Limiting contact between persons in different zones



Online classes for social distancing

For class sizes above 50 students



Nation-wide check in/out via mobile phone

Used in buildings or shops, enables swift contact tracing



Daily temperature declaration via NUS app

Self monitoring of health



Access to health services & Swab Testing

For all NUS students/staff with Acute Respiratory Infection



Mandatory mask wearing

All persons in Singapore are required to wear a mask outside of their residence

Useful resources:

- ✓ [Detailed safety & health measures in NUS](#)
- ✓ [Latest border control measures in Singapore](#)
- ✓ [NUS insurance coverage for COVID-19 treatment](#)



20,000+
students just like you
have experienced NUS
through 20+ years of
exchange.

Be part of the
NUS family!



Check out this
[video](#) on what a
day in the life an
NUS exchange
student is like!



Global Relations Office



See you in Singapore!

nus.edu.sg/gro/

NATIONAL UNIVERSITY
OF SINGAPORE

 nusgro

 facebook.com/nusgro

 ashlynn@nus.edu.sg

**NUS**
National University
of Singapore

Global Relations Office