

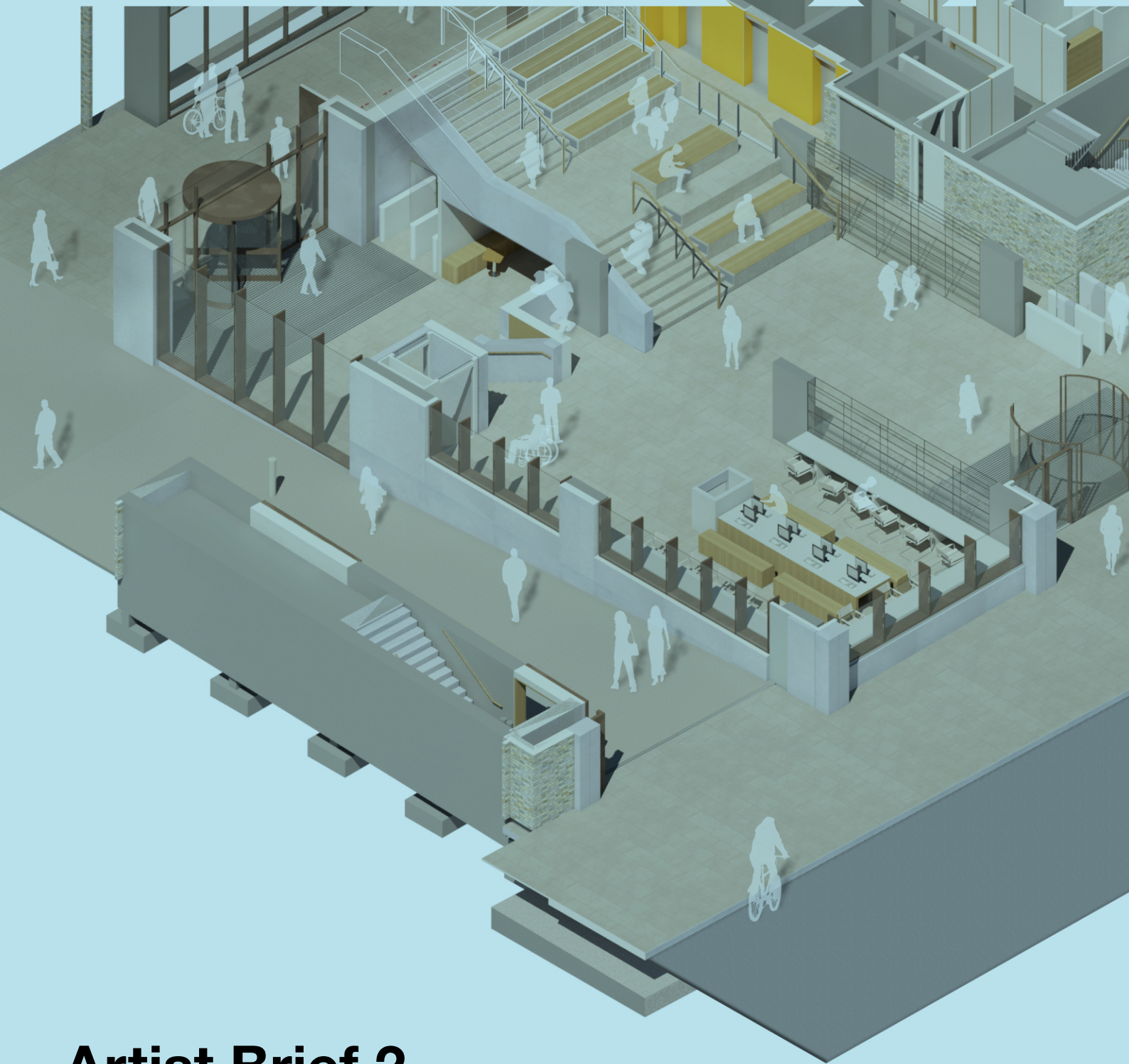

UCL



Artist Brief 2

Permanent commission for public access areas

**Digital Technologies /
Time Based Commission**

Introduction

UCL would like to invite an artist to develop a permanent public art work for the New Student Centre a strategically significant project within the Bloomsbury Campus 10 year masterplan. The building has been designed by Nicholas Hare Architects who are also leading on the refurbishment of the Bloomsbury Theatre located adjacent to the New Student Centre.

“The vision is to make UCL the most exciting university in the world at which to study and work. UCL aims to be the UK’s leading outward looking university, making a major contribution to the society in which we function and enhancing the lives of our students. The New Student Centre must support and reflect this scale of ambition and will be the benchmark for excellence for all future UCL construction projects and it should have the highest design, quality, sustainability and procurement approach. It should enhance the student experience and create a new and exciting student experience at UCL. The design must be sensitive to the surrounding built environment, in particular the adjacent listed buildings and Bloomsbury Conservation Area, while staying true to the ambition of UCL to create a ‘landmark’ building and be London’s Global University.”

- Extract from UCL’s New Student Centre project description



Gordon Street Facade

Key aspirations for the building

“This is a unique opportunity for UCL to demonstrate its core values. The building should be truly student focused, responsive to change, inspirational and enabling, capable of reinventing itself as trends in education develop, accessible and inclusive to all, and reflecting the diversity of its users. It is not a building that people should be in awe of but want to be part of – the architecture should be easy to read and use, memorable by the experience that it provides. It should be an exemplar for other universities worldwide.”

The facilities at the New Student Centre are designed to enhance the student experience and will have two core functions: student learning space and a new Student Enquiries Centre. UCL has a pressing need for new student study space and has a particular need to create a new level of access to computers. The new building will provide a variety of learning environments creating 1000 new study seats.

A key objective, and most pertinent to this commission, is the commitment to improve and encourage access through the building to the wider campus beyond. The building will act as a portal into the Bloomsbury campus as well as a destination in itself. The ground floor levels are completely open to the general public as well as students, with security barriers to restrict access to the upper floors and basement levels. Good levels of daylight and transparency through the spaces will help those unfamiliar with the building to find their way around. The building will be inclusive and welcoming and will ensure those with disabilities can make full use of the facilities. Clear and legible links through the building from Gordon Street to the Japanese Garden courtyard will create a strong sense of permeability.

A building of the highest quality is required. A simple and refined palette of high quality materials is proposed: exposed concrete, white oak, bronze anodised aluminum, and york stone. Minimising future maintenance has been a key driver in the selection of these robust and durable materials, helping contribute to the building's outstanding sustainability objectives.



View from Japanese Garden

Aspirations for the artwork

This commission will be awarded to an artist(s) who works with new technologies and time based media, who is interested in data visualisation. There are a range of pragmatic information distribution requirements that need to be developed for the student users of the Student Centre. The commission is aiming to explore how we communicate with Students, how to make the building transparent and open.

However, this commission will explore the potential for an artwork that expands the idea of data, how it is analysed and redistributed in unexpected, intriguing and creative ways through a digital installation.

The artist will carry out their own research into the data and information systems that support the Student Centre. It is notable that the design of the building has achieved BREEAM Outstanding at its design stage sustainability assessment, where a focus on materials innovation, efficient resources management and construction methods has been critical to the design process. It is clear that in the notion of information distribution and the nature of the building itself that there is a wealth of content to research and interpret within an artwork. Aesthetically this work will bring a different dynamic to the public spaces and explore ideas of communication, information design and interactivity

The artist appointed for this commission selected from the Slade School of Fine Art. This artist must have embraced digital technologies in the structural makeup of their practice. It is also important within this commission that the artist is interested in exploring consultative methods for data collection.

It is envisaged that the commission would be developed in partnership between the artist and CASA and the IT Infrastructure department (ISD) of UCL to ensure it effective integration into the building management systems and maintenance of the work. A relationship with the Bartlett would also be recommended in the development of this commission.

Location of this work must be in the main entrance / atrium area and associated with the Gordon Street entrance, but it will potential have a presence through the building into the student only areas of the building.

The work should be developed with consideration of the student experience, what it is to be a student in the heart of London. This building will be a place for quiet study but designed to allow for discussion, debate and group working. This sense of collaboration, shared endeavour and study is an important dimension to the commissioned work.



Artist Selection Process

The artist will be appointed through a competitive interview process. The Public Art Manager with the Slade Professor will review a long list of artists with a commissioning group made up of key project stakeholders. From this a shortlist of 3-4 artists will be selected and invited to interview.

Prior to attendance at the interview we would like to invite the shortlisted artists to prepare a short, no more than one side of A4, paper outlining why they are interested in the opportunity and some initial thought to how they would develop a concept proposal.

One artist will be appointed to deliver the commission.



Artist Scope of work

The appointed artist will work with the commission project group for the New Student Centre and the Public Art Manager at UCL to develop their concept proposal. This project group is made up of the Project Sponsor, representation from the Estates Department, the project architect, the Public Art Manager and the Slade Professor. This group will participate in the artist selection process but also support the artist through the commission.

The appointed artist is expected to develop their concept proposal through a process of consultation.

- Nicholas Hare Architects, the architects for the NSC are committed to supporting the work of the artist and they will be a first point of consultation for the appointed artist to explore the building and to discuss opportunities and constraints. The work will be located in the main atrium and the design and function of this space is critical to the legibility and understanding of how to use the building.

- A consultative group has been established during the development of the New Student Centre from the Learning Environments and Student Services. The artist will be invited to meet and consult representatives of this group as well as establishing their own informal consultative and research mechanism to inform the artwork.

- A representative of the estates department will be in the project group to ensure the ideas and proposed approach to the artwork is considered early on in terms of how it can be integrated into the building. As the building will be near to completion by spring 2018 the installation of the artwork must be planned as soon as possible.

- IT Infrastructure department (ISD) must be consulted

- CASA are a potential development partner in the project

Concept Development Proposal

Having consulted and carried out independent research the artist will be expected to prepare a high quality and detailed concept proposal which should include;

1. Detailed visualisations of the work which clearly set out the concept, information on the size, materials, weight and appearance of the artwork. Drawings should include perspectives and sections and elevations to scale.
2. A Maquette, if appropriate.
3. A written narrative outlining ideas, research and key concepts associated with the artwork, and its appropriateness for the building's space and function
4. A methodology for production and fabrication including details of preferred fabricators
5. Costplan for production and installation of the artwork within the project budget
6. Fabrication and installation time line
7. Consideration for maintenance, design life and long term sustainability of the proposed artwork

Planning Permission

If the proposed artwork is located within the new building then planning approval is highly unlikely to be needed. However, if the artwork proposed is an intervention within the Japanese Garden then approval may be required, in this case a detailed concept proposal will be submitted to the local planning authority for planning permission. This will be submitted by the UCL Estates Department but the artist's concept proposal documents must be suitable for inclusion in the planning application.

Detailed Design

The next stage of full detail design will commence receipt on full planning approval.

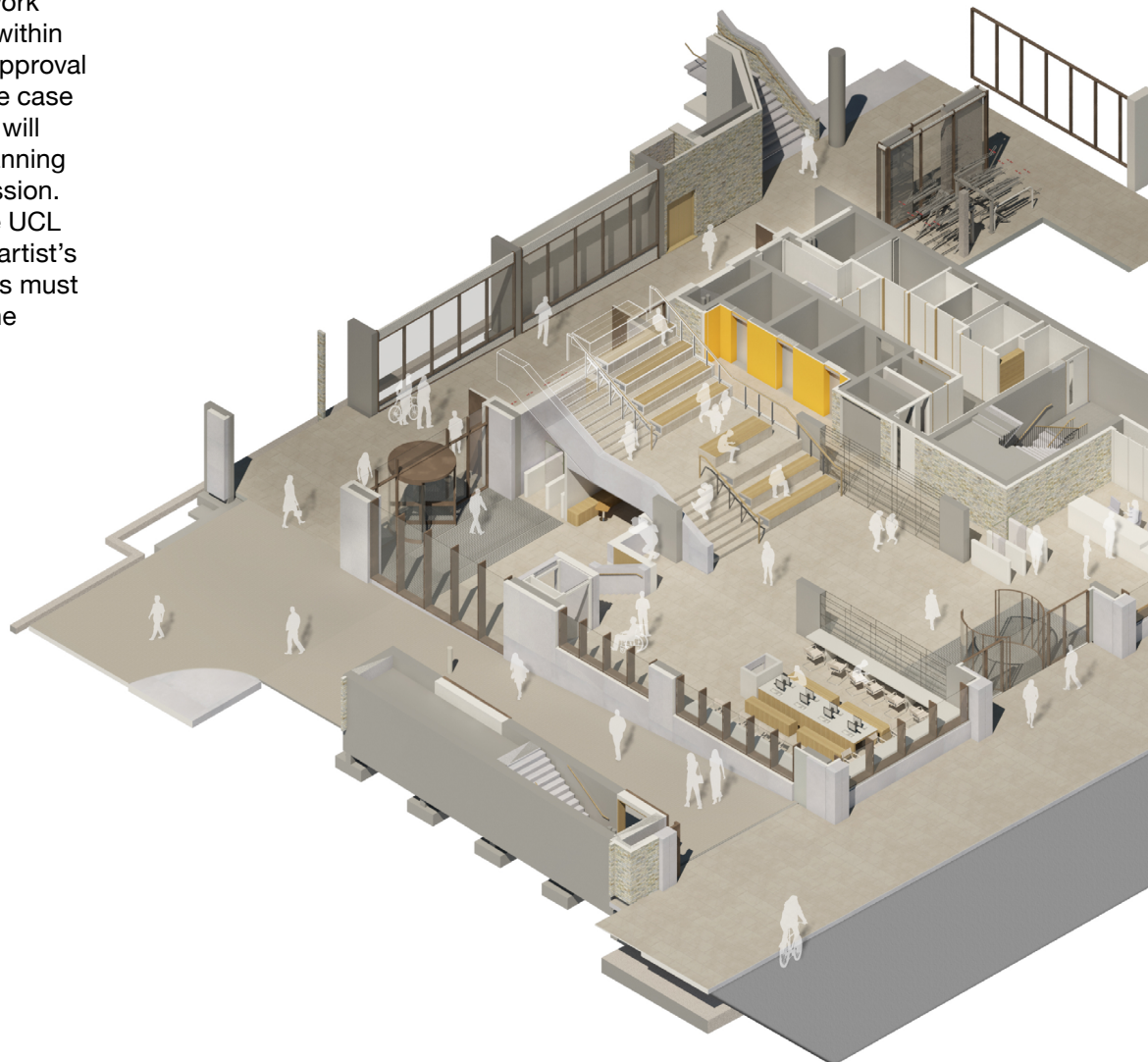

Programme

Budget

Contact

Key dates:

Artist Interview / appointment
5 December 2017

Consultation
December 2017 – ongoing

Briefing with architects
December 2017

Concept development
January – March 2018

Interim concept meeting
February 2018

Presentation of final concept
April 2018

Approvals Process
May 2018

Planning
June- August 2018

Detailed Design
August 2018

Fabrication
September – November 2018

Construction of new building complete
December 2018

Installation
TBC

Artist Fees (including all expenses)

Concept Development Fee
£6,000

Design Development Fee
£5,000

Production and Commission Fee
£8,000

Total £19,000 + VAT

Capital budget

The budget for the commissioned work is £81,000 +VAT

Capital costs are expected to include:

1. Material Costs
2. Fabrication / Manufacture
3. Fabricator project management costs
4. Any Specialist engineering costs
5. Transportation
6. Site preparation, installation and remediation
7. Documentation of the work

All submissions must be received electronically and should be sent to Sam Wilkinson, Public Art Manager to publicart@ucl.ac.uk