

UCL Astrea
presents...

Project Bench
2023



What is Project Bench?

The installation of a 'Happy to Chat' bench in four locations across UCL's Estate

Dedicated to five inspiring UCL women

Part of a national campaign to combat loneliness and address the theme of isolation

To provide opportunities for students and staff to connect with each other

Where are
the benches
located?
#1

The Main Quad, in front of the Portico

GOWER STREET, LONDON, WC1E 6BT



Where are
the benches
located?
#2

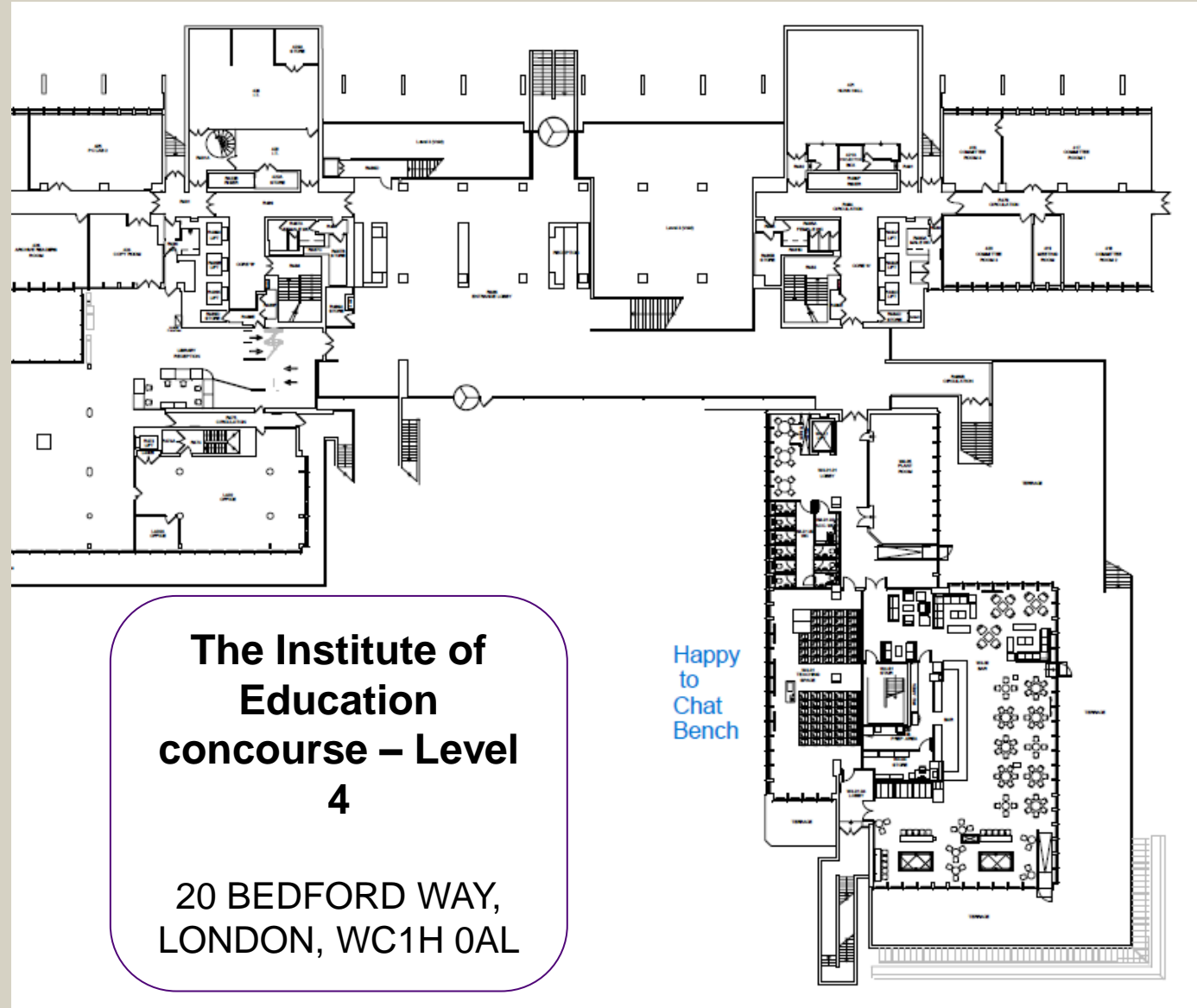

Where are
the benches
located?
#3

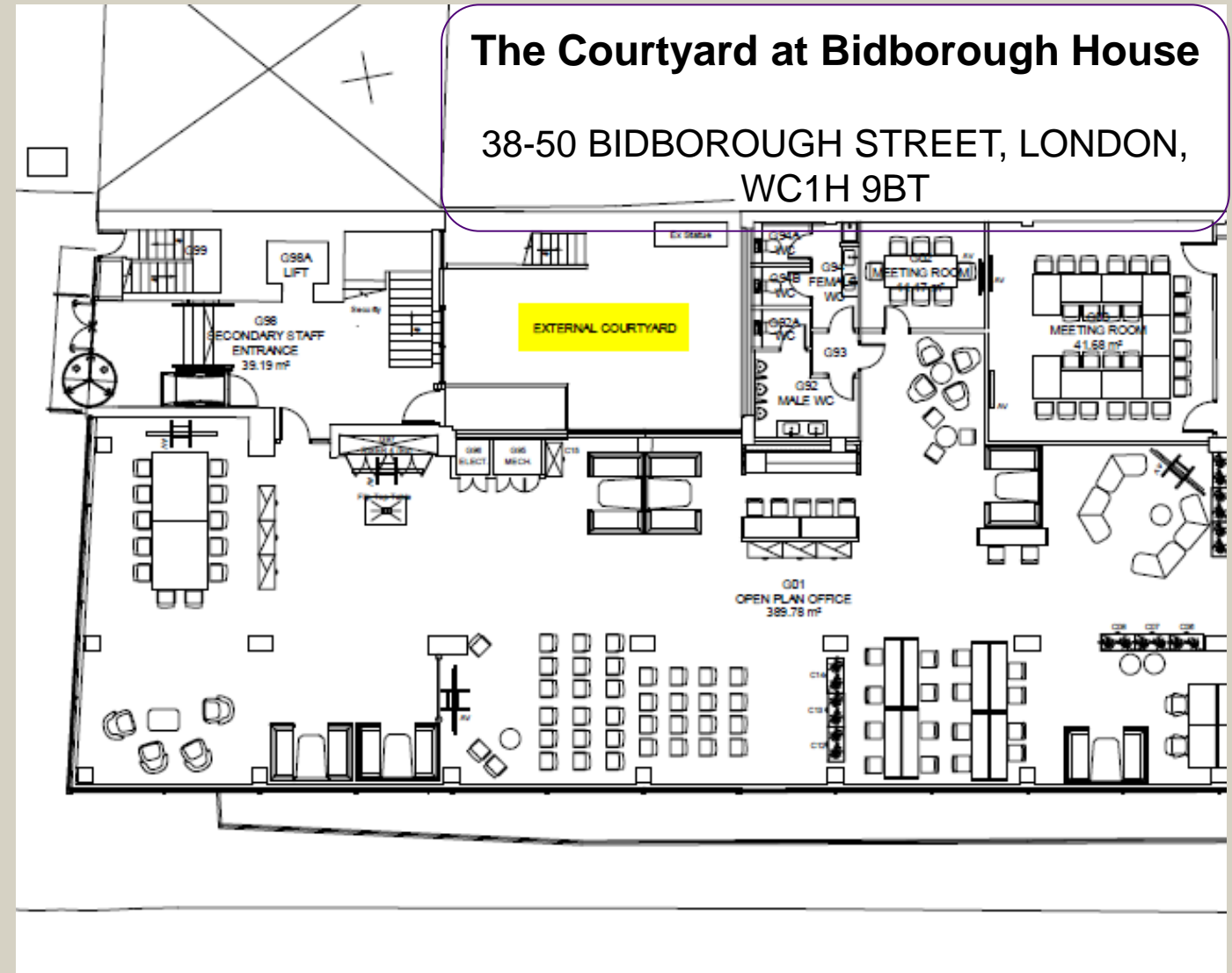

Where are
the benches
located?
#4

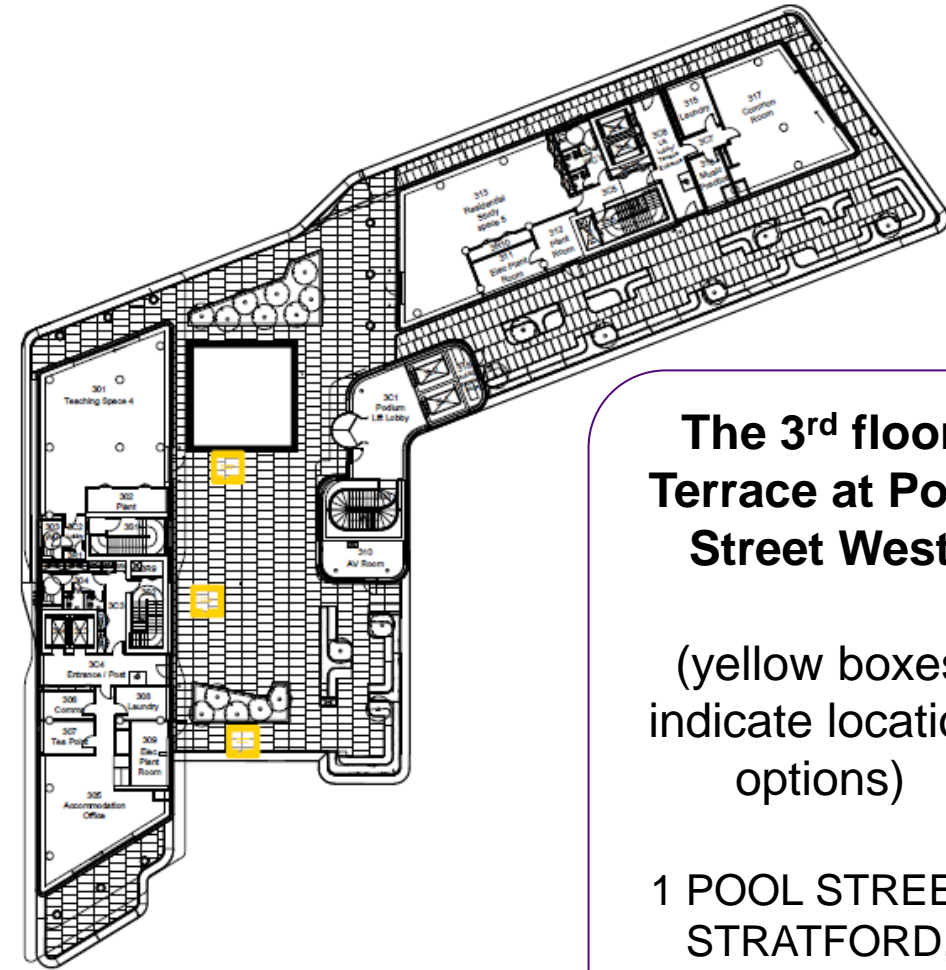

**The 3rd floor
Terrace at Pool
Street West**

(yellow boxes
indicate location
options)

1 POOL STREET,
STRATFORD,
LONDON, E20 2AF

Who are the benches dedicated to?



Elizabeth Garrett Anderson

Pioneer of women's rights in medicine and society.



Bernice Lake

First woman from the Eastern Caribbean to be appointed Queen's Counsel in 1985.



Kathleen Lonsdale

One of the first two women to become a Fellow of the Royal Society.



Constance Markievicz

First woman elected to the British House of Commons.



Sarah Parker Remond

A free-born African American radical, suffragist, anti-slavery activist and later, a physician.

Five of UCL's inspiring women

What do UCL's benches look like?

With a distinctive visual theme, the benches represent women through the ages

- The words *'Happy to Chat bench: sit here if you don't mind someone stopping to say hello'* are inscribed along the top left of the bench.
- The top right of the bench is the dedication to UCL's inspiring women.
- There are QR codes linking to the Astrea Project Bench webpage, where profiles of our chosen women and other discussion materials can be accessed
- <https://www.ucl.ac.uk/astrea/happy-chat-benches>



When is the launch?

The launch of the first bench in the main Quad is planned for Monday 11th September from 2pm

It will be attended by Aimie Chapple, who will officiate the proceedings

There will be an activity to participate in, and the event will be publicised in TheWeek@UCL

Following the main launch, there will be 'soft' launches in the other locations